

UBREATH®

Wearable Mesh Nebulizer
Quick Reference Guide



e-LinkCare Meditech Co., Ltd.
www.e-linkcare.com
info@e-linkcare.com

1 - Preparing the nebulizer -

- Carefully remove all components from the packaging.
- Follow the steps below to thread the elastic cord into the holes of mask properly before use.

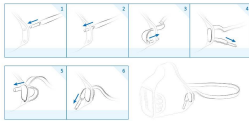

- Open the medicine container by pulling up the lid of medication container and fill the medicine container with isotonic saline solution or medicine slowly.



2 - Performing inhalation -

NOTE:
The recommended fill volume is a maximum of 6 mL and minimum of 2 mL.

- Place the medicine container into the rectangular shaped slot of the mask or mouthpiece, the medicine container shall fit firmly with it.



- Join the medicine container with remote controller by the connection cable.



- Based on doctor's advice or patient's actual demand, choose mouthpiece or mask before inhalation.
A. If you are using the mouthpiece for treatment, place the mouthpiece between your teeth, with your lips firmly sealed around the mouthpiece.
B. If you are using the wearable mask, place the mask over your mouth and nose, then put the elastic cord around your ears and make sure the mask is comfortable placed.



- Slide the power button to "On" mode then press the start button on the remote controller to initiate the inhalation. If you wish to halt the inhalation, press the button again to stop or slide the power button to "Off" mode.
- Start inhalation with relaxed posture. Inhale slowly and deeply, hold your breath briefly (5 to 10 seconds) and then exhale quickly.
- When the medication is depleted, the device will beep for three times and the LED indicator will start blinking orange for three seconds, then the device will shut off automatically.

- NOTE:
- Please do not block the hole of mouthpiece with your tongue when using the mouthpiece. Otherwise, the nebulization rate will decrease.
 - When the medication is close to depletion, please do not tilt or shake the nebulizer, this may cause termination of nebulization processing.
 - Please provide close supervision when it is used by children or compromised individuals.

3 - Rate adjustment -

The nebulization rate can be adjusted by double clicking the button on the remote controller. The LED indicator on the remote controller represents different nebulization rate, they are instructed as following.

- Low rate Medium rate High rate

4 - Cleaning -

- Remove the mouthpiece or mask from the medicine container.
- Open the lid of medicine container and discard the remaining medication.
- Add 4 mL of pure water into the medicine container, close the lid then gently shake for 10 seconds.
- Switch on the nebulizer for 2-3 minutes to remove any medicine residue from the mesh first, then wait till all liquid is sprayed.
- Power off the nebulizer and seal the medicine container with dust plug.
- Before and after using the mask/mouthpiece, rinse with pure water and let it air dry.

- NOTE:
- The nebulizer requires cleaning and disinfection before and after use each time.
 - Do not use abrasive detergents and never immerse the complete device in water.
 - Do not put the device or accessories in a dishwasher.

5 - Disinfection -

It's important to keep your UBREATH® Wearable Mesh Nebulizer disinfected at all times before assembly.

- Add about 4mL of 75% medical alcohol to the container; close its lid and gently shake it, then open the lid to drain the remaining alcohol.
- Use a medical cotton swab to immerse 75% of medical alcohol to disinfect the spray outlet and the outside of the chamber.
- After disinfection, rinse the inside of the spray chamber; the spray outlet and the outside of the spray chamber with purified water twice and dry.
- Gently wipe the mask/mouthpiece with a cotton ball soaked in medical alcohol (alcohol concentration 70% ~ 75%) after cleaning, then rinse it twice with pure water and dry.

6 - Troubleshooting -

Problem	Possible cause	Solution
Non-operation even if power switch is on (power indicator does not light and no mist comes out)	Battery power is running out	Recharge the battery
No mist or low mist is produced	The mesh hole is clogged Low level medicine left in medicine container	Clean and disinfect the medication container then restart the nebulizer Fill the medicine container with more medication if needed
Red LED flashes constantly then automatically turn off	faulty connection between medicine container and remote controller	Insert the connection cable correctly into both medicine container and remote controller
Orange LED flashes constantly then automatically turn off	Medicine is finished or the nebulizer is shaking	Check the medication level then restart the nebulizer
Orange LED does not flash when recharging	Battery is not recharged or the remote controller is not switched on	Switch on the remote controller and connect the recharge cable again

For complete instructions, please refer to the User's Manual included in your package. For additional questions or issues, please contact your dealer for help.

2144Care Meditech Co., Ltd.
Unit 46, C-Block, Baimen Park 2
Linyue Road, Xixun Township,
Huizhou City, Guangdong, China

Manufacturer Site
No. 30 Baimen Yingsheng Road,
215102 Taizhou, Zhejiang, China
1340200201

Attention

By approving the enclosed design draft, you (e-LinkCare's Customer) accept all responsibility for the accuracy of the design.
If an error is detected following the printing or manufacturing of a material, you (e-LinkCare's Customer) are responsible for the cost of any inventory which is deemed unsuitable for sale.



物料代码Part Number	13405016001	物料名称Description	UBREATH NS180 NS280 Non-CE Wearable Mesh Nebulizer QRG (EN) with new address
材质Material	128g双玻纸水性上光油	尺寸Size	90x120mm(折后尺寸)
设计师Designer	Elsa	设计复核Artwork checked by	
设计日期Design Date	2019/12/12 C	生效日期Effective Date	
结构设计复核Structural Checked by		产品管理审批Approved by P.M.T.	
注册审批Approved by RA		质量审批Approved by QA	
市场销售审批Approved by MKT/Sales(if need)		客户审批Approved by Customer (if need)	

